

旋启式止回阀 CAST STEEL SWING CHECK VALVE

型号编制说明 FIGURE NUMBER SYSTEM

1	规格Size	英制系列以xxin表示;公制系列以xx表示,单位mm省略					
2	驱动方式 Operation type	不适用Not suitable					
3	阀门类别 Valve Type	H-止回阀 Check Valve					
4	压力等级 Pressure	0-PN10	1-PN16class150	2-PN25	3-class300	4-PN40class400	6-PN64 class600
		9-class900	10-PN100	15-class1500	16-PN160	20-PN200	25-class2500
5	连接方式 Ends	RF-突面法兰Raised Face	FF全平面法兰Flat Face	MFM凹凸法兰Male and Female Face	TG槽面法兰Tongue and Groove face		
		RJ环接面法兰Ring Joint	BW对接焊 Butt weld		WF-对夹式 Wafer Type		
6	结构形式 Structure Type	1-升降式 Lift Type	4-旋启单瓣式 Single Disc Swing type	6-旋启双瓣式 Double Disc Swing type	7-斜盘式 Tilting Disc Type		
7	壳体材料 Basic Material	C-WCB	C-C5	C6-WC6	C9-WC9	BL-LCB	CL-LCC
		8-CF8	8M-CF8M	3-CF3	3M-CF3M	ML-MONEL	
8	*阀座密封面 或衬里材料 Material of Seat face or Liner	H-Cr13系不锈钢Cr13 S.S		E-18-8系不锈钢18-8 S.S		R-Mo2Ti系不锈钢Mo2Ti S.S	
		D-渗氮钢nitriding steel		M-蒙耐尔合金Monel Alloy		Y-硬质合金Hard Face	

- 注: 1、*由阀体直接加工的阀座密封面材料代号用W表示
Use "W" to express seat sealing surface material which is processed directly by valve body.
2、*当密封副的密封面材料不同时,以硬度低的材料代号表示
When the materials of sealing surface are different, use low hardness material symbol to express.
3、型号中未列出的其他特殊要求必须在订单号写明
Special Requirements not shown, should be indicated in the purchase order
4、样本中列出的型号不涉及压力、口径及阀门的材料编号,由用户给定
The models in the sample book have no reference to pressure, sizes and valve material symbols, they are to be decided by users.

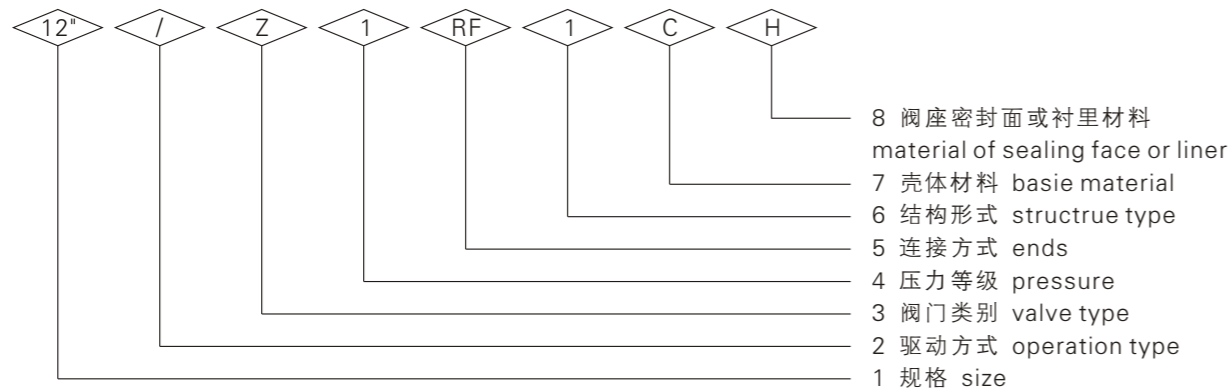

型号示例: FOR example

8" H1RF4CH

止回阀, 8"ANSI CLASS 150, 突面法兰连接, 单瓣旋启式、壳体(阀体、阀盖、阀瓣)材料WCB, 阀座密封面材料13Cr。
Check valve, 8" ANSI CLASS 150, Raised Face Ends, Single Disc Swing type, Body & Disc Cast Steel WCB, Seat sealing face material 13Cr.

50-H2WF68W

止回阀, DN50 PN25, 对夹连接, 双瓣旋启式, 壳体(阀体、阀盖、阀瓣)材料CF8, 阀座密封面本体加工。
Check valve, DN50 PN25, Wafer type, Double Disc Swing type, Body & Bonnet&Disc Stainless Steel CF8, Seat sealing face Body Machined.

旋启式止回阀 CAST STEEL SWING CHECK VALVE

铸钢旋启式止回阀的结构特征 Material List of Cast Steel Swing Type check Valve

栓接阀盖, 中法兰垫片的型式可根据压力等级的不同进行选择; CLASS600的止回阀可采用压力自紧密封结构。
Bolted bonnet, and the type of middle flange gasket may be different according to pressure class; CLASS600 check valve may adopt pressure self-tightening seal structure.

阀瓣限位装置, 防止阀瓣打开位置过高无法关闭。
Disc stop device to prevent disc from being opened too high, thus causing failure to be closed down.

实心销轴安装精确, 强度高, 保证了阀门的使用性能和使用寿命。
Solid pin is precisely installed And provided with high intensity to ensure operational performance and service life of valve.

摇杆具有足够的强度, 关闭时有足够的自由度以利于阀瓣关闭。
Rocker arm is given enough intensity. Upon being closed down, it has enough freedom for the closedown of valve disc.

阀瓣具有足够的强度和刚度, 阀瓣密封面可根据用户要求堆焊金属材料或镶嵌非金属材料。
Valve disc is given enough intensity and rigidity. Disc sealing surface may be built-up welded with metal material or inlaid with nonmetal material responding to users' requests.

大口径的止回阀设计有吊环, 方便吊起。
Large-caliber check valves are provided with lifting rings for the convenience of hoisting.

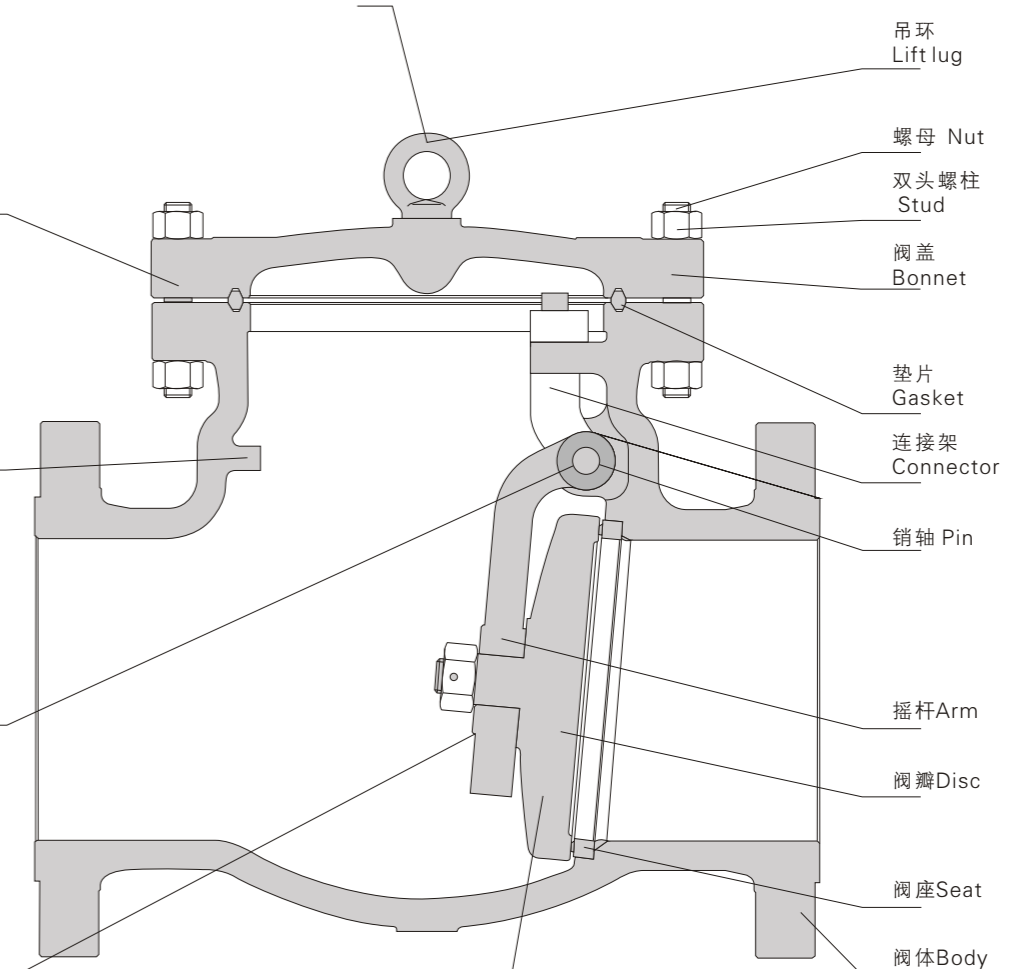

旋启式止回阀 CAST STEEL SWING CHECK VALVE

铸钢旋启式止回阀的材料明细 MATERIAL LIST OF CAST STEEL SWING TYPE CHECK VALVE

序号 No.	零件名称 Part Name		碳钢系列 Carbon Steel	不锈钢系列 Stainless Steel	合金钢系列 Alloy Steel	低温钢系列 Low Temperature Steel
1	阀体	Body	ASTM A216 GR WCB	ASTM A351 GR CF8	ASTM A217 GR WC6	ASTM A352 GR LCB
2	阀座	Seat	ASTM A105	ASTM A105	ASTM A182 GR F304	ASTM A182 GR F304
3	阀瓣	Disk	ASTM A216 GR WCB	ASTM A351 GR CF8	ASTM A217 GR WC6	ASTM A352 GR LCB
4	摇杆	Arm	ASTM A216 GR WCB	ASTM A351 GR CF8	ASTM A217 GR WC6	ASTM A352 GR LCB
5	销轴	Pin	ASTM A182 GR F6a	ASTM A276 GR TYPE 304	ASTM A182 GR F304	ASTM A182 GR F304
6	连接架	Connector	ASTM A216 GR WCB	ASTM A351 GR CF8	ASTM A217 GR WC6	ASTM A352 GR LCB
7	垫片	Gasket	柔性石墨+SS304	柔性石墨+SS304	柔性石墨+SS304	柔性石墨+SS304
8	阀盖	Bonnet	ASTM A216 GR WCB	ASTM A351 GR CF8	ASTM A217 GR WC6	ASTM A352 GR LCB
9	双头螺柱	Stud	ASTM A193 GR B7	ASTM A194 GR CF8	ASTM A193 GR B7	ASTM A194 GR B8
10	螺母	Nut	ASTM A194 GR 2H	ASTM A193 GR 8	ASTM A194 GR 4	ASTM A193 GR 8

提示：1、壳体材料压力温度等级表见附录

Remark: Pressure and temperature rating of casing material referred to Appendix

2、壳体材料化学成分及力学性能见附录

Chemical compositions and mechanical property of casing material referred to Appendix

3、常见内件材料的组合及使用温度见附录

Commonly-used trim materials and service temperature referred to Appendix

技术性能规范 Technical Specification

设计标准 Design Standard	BS1868						
压力温度等级 Pressure-Temperature Rating	ASME B16.34						
结构长度 Face-Face	ASME B16.10						
法兰型式尺寸 Flange Ends	ASME B16.5、ASME B16.47						
对焊端连接 Buttwelding Ends	ASME B16.25						
检验与试验 Inspection & Test	API598						
公称压力 Norminal Pressure (Class)	150	300	400	600	900	1500	
试验压力 (MPa) Test-Pressure	壳体试验 Shell Test	2.93	7.55	10.0	15.0	22.5	37.5
	高压密封 High Pressure Seal Test	2.07	5.52	7.31	11.03	16.5	27.5
	低压密封 Low Pressure Seal Test	0.6					
适用温度 Applicable Temperature	-196℃-550℃ (不同的工况温度选用不同材质) Different raw material for different work temperature						
适用介质 Applicable Medium	水、油、气及各类腐蚀性介质 (不同的介质选用不同材质) Water、Oil、gas and other causticity medium (Different raw material for different medium)						

旋启式止回阀 CAST STEEL SWING CHECK VALVE

旋启式止回阀供货范围 CAST STEEL SWING CHECK VALVE PRODUCT LINE

规格 Size		栓接阀盖 Bolted bonnet								压力密封阀盖 Pressure Sealed Bonnet					
		GB系列				BS系列				GB系列			BS系列		
DN	NPS	PN1.6	PN2.5	PN4.0	PN6.4	PN10.0	CL150	CL300	CL600	PN16.0	PN25.0	CL600	CL900	CL1500	CL2500
40	1-1/2	*	*	*	*	*	*	*	*	*	*	*	*	*	*
50	2	*	*	*	*	*	*	*	*	*	*	*	*	*	*
65	2-1/2	*	*	*	*	*	*	*	*	*	*	*	*	*	*
80	3	*	*	*	*	*	*	*	*	*	*	*	*	*	*
100	4	*	*	*	*	*	*	*	*	*	*	*	*	*	*
125	5	*	*	*	*	*	*	*	*	*	*	*	*	*	*
150	6	*	*	*	*	*	*	*	*	*	*	*	*	*	*
200	8	*	*	*	*	*	*	*	*	*	*	*	*	*	*
250	10	*	*	*	*	*	*	*	*	*	*	*	*	*	*
300	12	*	*	*	*	*	*	*	*	*	*	*	*	*	*
350	14	*	*	*	*	*	*	*	*	*	*	*	*	*	*
400	16	*	*	*	*	*	*	*	*	*	*	*	*	*	*
450	18	*	*	*	*	*	*	*	*	*	*	*	*	*	*
500	20	*	*	*	*	*	*	*	*	*	*	*	*	*	*
600	24						*	*	*			*	*	*	
650	26						*	*	*			*	*		
700	28						*	*	*			*	*		
750	30						*	*	*			*	*		
800	32						*	*							
900	36						*	*							

欲订购表中列出的产品可与本公司销售部门联系。

For sizes classes not shown please contact our Sales Department

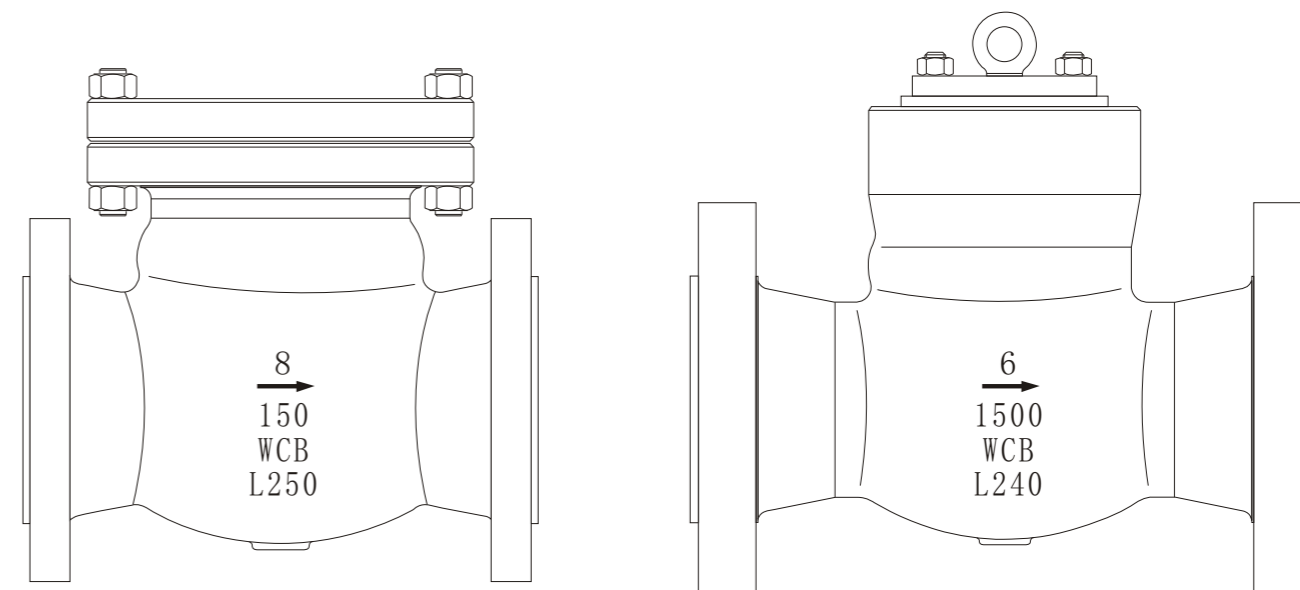

旋启式止回阀 CAST STEEL SWING CHECK VALVE CLASS150Lb~300Lb

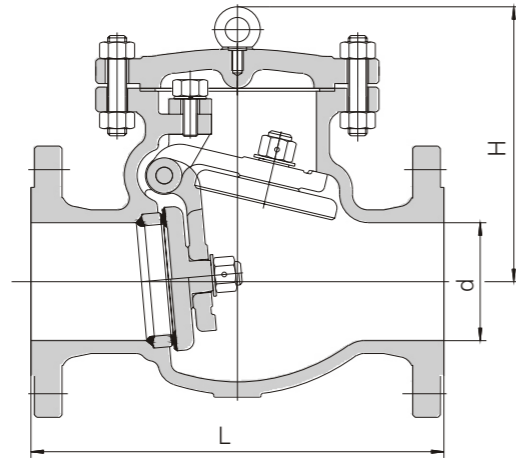

REMARK:EYE SCREW FOR NPS5" & LARGER

设计标准 Design Standard

- 1.Design and Manufacture Standard 设计制造标准: API6D or BS18608
- 2.Material Pressure-Temp Standard 压力-温度基准: CLASS B16.34
- 3.End to End Dimension Standard 结构长度标准: CLASS B16.10
- 4.Flange Ends Dimension Standard 法兰连接端尺寸: CLASS B16.5(NPS≤24") ASME B16.47 (NPS>24")
- 5.Inspection and Test Standard 检验和试验标准: API 598 or API 6D

MAIN DIMENSION

SIZE		CLASS 150						CLASS 300					
NPS		L			d	H	Weight (Kg)	L			d	H	Weight (Kg)
inch	mm	RF	RTJ	BW				RF	RTJ	BW			
2	50	203	216	203	51	132	15	267	283	267	51	144	20
2 1/2	65	216	229	216	64	147	20	292	308	292	64	169	35
3	80	241	254	241	76	176	27	318	333	318	76	210	40
4	100	292	305	292	102	198	45	356	371	356	102	260	61
5	125	330	343	330	127	255	58	400	416	400	127	295	80
6	150	356	368	356	152	320	69	445	460	445	152	326	130
8	200	495	508	495	203	380	131	533	549	533	203	380	190
10	250	622	635	622	254	440	219	622	638	622	254	440	296
12	300	699	711	699	305	480	321	711	727	711	305	520	450
14	350	787	800	787	337	530	380	838	854	838	337	540	640
16	400	864	876	864	387	580	560	864	879	864	387	588	850
18	450	978	991	978	438	618	630	978	994	978	438	670	1030
20	500	978	991	978	489	657	770	1016	1035	1016	489	720	1330
24	600	1295	1308	1295	591	760	960	1346	1368	1346	591	850	1950
26	650	1295	-	1295	633	840	1250	1346	1372	1346	633	920	2300
28	700	1448	-	1448	684	920	1580	1499	1524	1499	684	1150	2600
30	750	1524	-	1524	735	980	1950	1594	1619	1594	735	1260	3200

旋启式止回阀 CAST STEEL SWING CHECK VALVE CLASS600Lb~900Lb

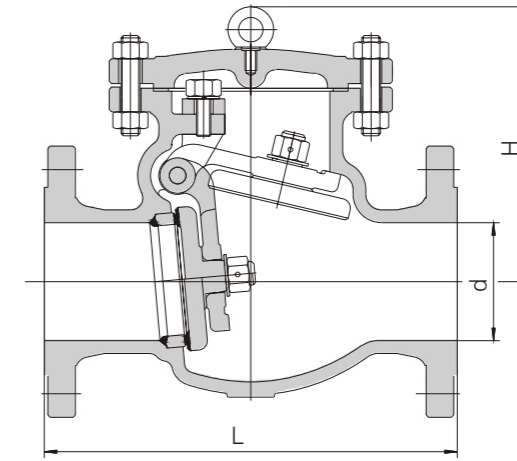

REMARK:EYE SCREW FOR NPS5" & LARGER

设计标准 Design Standard

- 1.Design and Manufacture Standard 设计制造标准: API6D or BS18608
- 2.Material Pressure-Temp Standard 压力-温度基准: CLASS B16.34
- 3.End to End Dimension Standard 结构长度标准: CLASS B16.10
- 4.Flange Ends Dimension Standard 法兰连接端尺寸: CLASS B16.5(NPS≤24") ASME B16.47 (NPS>24")
- 5.Inspection and Test Standard 检验和试验标准: API 598 or API 6D

MAIN DIMENSION

SIZE		CLASS 600						CLASS 900					
NPS		DN			d	H	Weight (Kg)	L			d	H	Weight (Kg)
inch	mm	RF	RTJ	BW				RF	RTJ	BW			
2	50	292	295	292	51	170	28	368	371	368	51	200	48
2 1/2	65	330	333	330	64	178	40	419	422	419	64	220	75
3	80	356	359	356	76	246	68	381	384	381	76	280	95
4	100	432	435	432	102	290	117	457	460	457	102	320	135
5	125	508	511	508	127	320	155	559	562	559	127	360	200
6	150	559	562	559	152	360	192	610	613	610	152	400	264
8	200	660	664	660	203	430	340	737	740	737	203	480	424
10	250	787	791	787	254	502	515	838	841	838	254	560	730
12	300	838	841	838	305	554	750	965	968	965	305	632	1070
14	350	889	892	889	337	595	890	1029	1038	1029	322	680	1180
16	400	991	994	991	387	680	1303	1130	1140	1130	373	780	1790
18	450	1092	1095	1092	438	778	1800	1219	1232	1219	423	880	2500
20	500	1194	1200	1194	489	970	2150	1321	1334	1321	471	1050	3080
24	600	1397	1407	1397	591	1100	3200	1549	1568	1549	522	1200	4600

旋启式止回阀 CAST STEEL SWING CHECK VALVE CLASS150Lb~250Lb

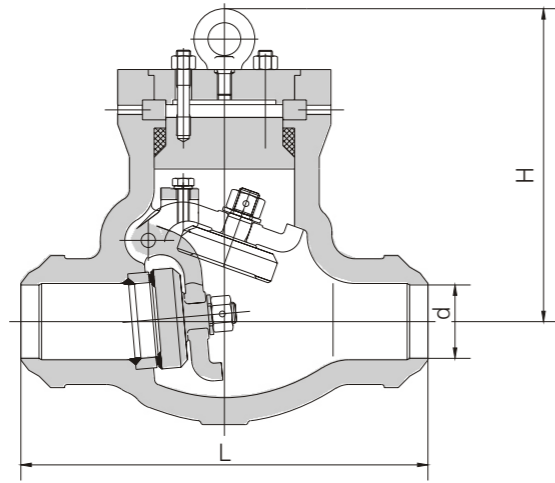

REMARK: EYE SCREW FOR NPS5" & LARGER

设计标准 Design Standard

- 1.Design and Manufacture Standard 设计制造标准: API6D or BS18608
- 2.Material Pressure-Temp Standard 压力-温度基准: CLASS B16.34
- 3.End to End Dimension Standard 结构长度标准: CLASS B16.10
- 4.Flange Ends Dimension Standard 法兰连接端尺寸: CLASS B16.5(NPS≤24") ASME B16.47 (NPS>24")
- 5.Inspection and Test Standard 检验和试验标准: API 598 or API 6D

MAIN DIMENSION

SIZE		CLASS 1500						CLASS 2500					
NPS		dn			d	H	Weight (Kg)	L			d	H	Weight (Kg)
inch	mm	RF	RTJ	BW				RF	RTJ	BW			
2	50	368	371	368	51	210	48	451	454	451	42	230	68
2 1/2	65	419	422	419	64	240	75	508	514	508	52	260	100
3	80	470	473	470	76	303	120	578	584	578	62	330	165
4	100	546	549	546	102	340	180	673	683	673	87	370	260
5	125	673	676	673	127	380	294	794	807	794	96	410	440
6	150	705	711	705	144	430	385	914	927	914	131	460	580
8	200	832	841	832	192	500	634	1022	1038	1022	179	530	970
10	250	991	1000	991	239	590	1140	1270	1292	1270	223	620	1700
12	300	1130	1146	1130	287	660	1650	1422	1445	1422	265	690	2600
14	350	1257	1276	1257	315	710	2000	-	-	-	-	-	-
16	400	1384	1407	1384	360	820	2700	-	-	-	-	-	-

升降止回阀 CAST STEEL LIFT CHECK VALVE CLASS150Lb~300Lb

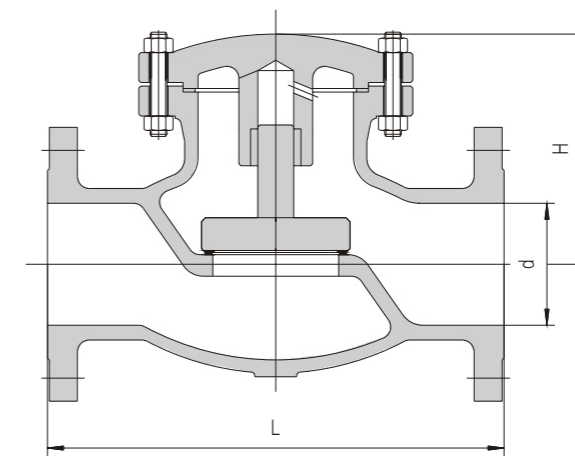

设计标准 Design Standard

- 1.Design and Manufacture Standard 设计制造标准: API6D or BS18608
- 2.Material Pressure-Temp Standard 压力-温度基准: CLASS B16.34
- 3.End to End Dimension Standard 结构长度标准: CLASS B16.10
- 4.Flange Ends Dimension Standard 法兰连接端尺寸: CLASS B16.5(NPS≤24") ASME B16.47 (NPS>24")
- 5.Inspection and Test Standard 检验和试验标准: API 598 or API 6D

MAIN DIMENSION

SIZE		CLASS 150						CLASS 300					
NPS		L			d	H	Weight (Kg)	L			d	H	Weight (Kg)
inch	mm	RF	RTJ	BW				RF	RTJ	BW			
1/2	15	108	119	108	13	76	3	152	162	152	13	78	5
3/4	20	117	130	117	19	76	4	178	191	178	19	82	6
1	25	127	140	127	25	98	5	203	216	203	25	102	8
1 1/4	32	140	153	140	32	102	7	216	229	216	32	106	11
1 1/2	40	165	178	165	38	115	8	229	242	229	38	118	13
2	50	203	216	203	51	140	15	267	283	267	51	140	26
2 1/2	65	216	229	216	64	162	22	292	308	292	64	164	33
3	80	241	254	241	76	168	28	318	333	318	76	178	50
4	100	292	305	292	102	194	42	356	371	356	102	195	86
5	125	356	368	356	127	210	60	400	416	400	127	223	120
6	150	406	419	406	152	226	75	445	460	445	152	245	180
8	200	495	508	495	203	250	118	533	549	533	203	280	220
10	250	622	635	622	254	275	194	622	638	622	254	336	310
12	300	699	711	699	305	332	320	711	727	711	305	380	510

升降止回阀 CAST STEEL LIFT CHECK VALVE

CLASS600Lb~900Lb

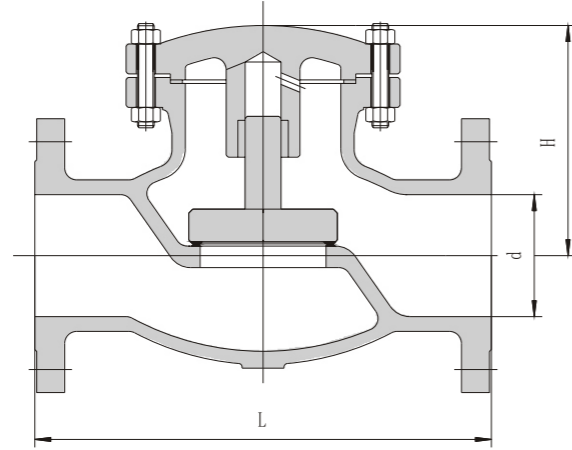

设计标准 Design Standard

- 1.Design and Manufacture Standard 设计制造标准: API6D or BS18608
- 2.Material Pressure-Temp Standard 压力-温度基准: CLASS B16.34
- 3.End to End Dimension Standard 结构长度标准: CLASS B16.10
- 4.Flange Ends Dimension Standard 法兰连接端尺寸: CLASS B16.5(NPS≤24")
ASME B16.47 (NPS>24")
- 5.Inspection and Test Standard 检验和试验标准: API 598 or API 6D

MAIN DIMENSION

SIZE		CLASS 1500						CLASS 2500					
NPS		L			d	H	Weight (Kg)	L			d	H	Weight (Kg)
inch	mm	RF	RTJ	BW				RF	RTJ	BW			
2	50	292	295	292	51	152	32	368	371	368	50	180	50
2 1/2	65	330	333	330	64	167	45	419	422	419	64	200	65
3	80	356	359	356	76	178	68	381	384	381	74	235	88
4	100	432	435	432	102	215	98	457	460	457	100	270	140
5	125	508	511	508	125	240	155	559	562	559	125	300	210
6	150	559	562	559	152	279	230	610	613	610	150	350	300
8	200	660	664	660	200	328	300	737	740	737	200	400	390